

The image shows a rustic interior of a Tuscan colonial house. In the foreground, a dining table is covered with a white and green checkered tablecloth, surrounded by wooden chairs. In the middle ground, a light-colored sofa is positioned against the wall. A large, stone fireplace with a white chimney hood is the central feature. To the right, a white armchair is visible. The floor is made of large, reddish-brown square tiles. The walls are light-colored with some exposed stone patches. A window with dark shutters is on the left. A small television is on a stand near the fireplace. A white pendant light hangs from the ceiling. The text 'TOSCANA CASA COLONICA' is overlaid in large white letters, and 'STRADA PROVINCIALE, ASCIANO' is in smaller white letters below it. A watermark for 'immobiliare SANTALFREDO' is also present.

TOSCANA CASA COLONICA

STRADA PROVINCIALE, ASCIANO

immobiliare
SANTALFREDO

TOSCANA CASA COLONICA

250.000 €

Thinking of Tuscany immediately reminds timeless images of hilly landscapes: the view is lost among vineyards, olive groves and elegant rows of cypress trees. In the background, the reassuring presence of this beautiful farmhouse, the result of a recovery and enhancement of a farmhouse. The poetics of these ...

130 mq | 5 locali | 3 bagni

 i m m o b i l i a r e
SANTALFREDO

Telefono: 039 690 81 37 - Email: info@immobiliariesantalfredo.it



immobiliare
SANTAFREDO

TOSCANA CASA COLONICA

... places can be read in the skilful renovation carried out with mastery, an intervention that has not canceled the patina of the typical weather of the farmhouse.

Residence Borgo ...

Le necessità, i sogni legati alla casa cambiano e per ognuno sono diversi. La vera abilità è quella di trovare la soluzione per soddisfare ognuno di queste persone.

... Beccanella is located just 2 km from Asciano, in a strategic position with respect to the Abbey of Monte Oliveto Maggiore, Siena, Montalcino, Montepulciano and only 100 km from the ...

is immobiliare
SANTALFREDO

Telefono: 039 690 81 37 - Email: info@immobiliariesantalfredo.it

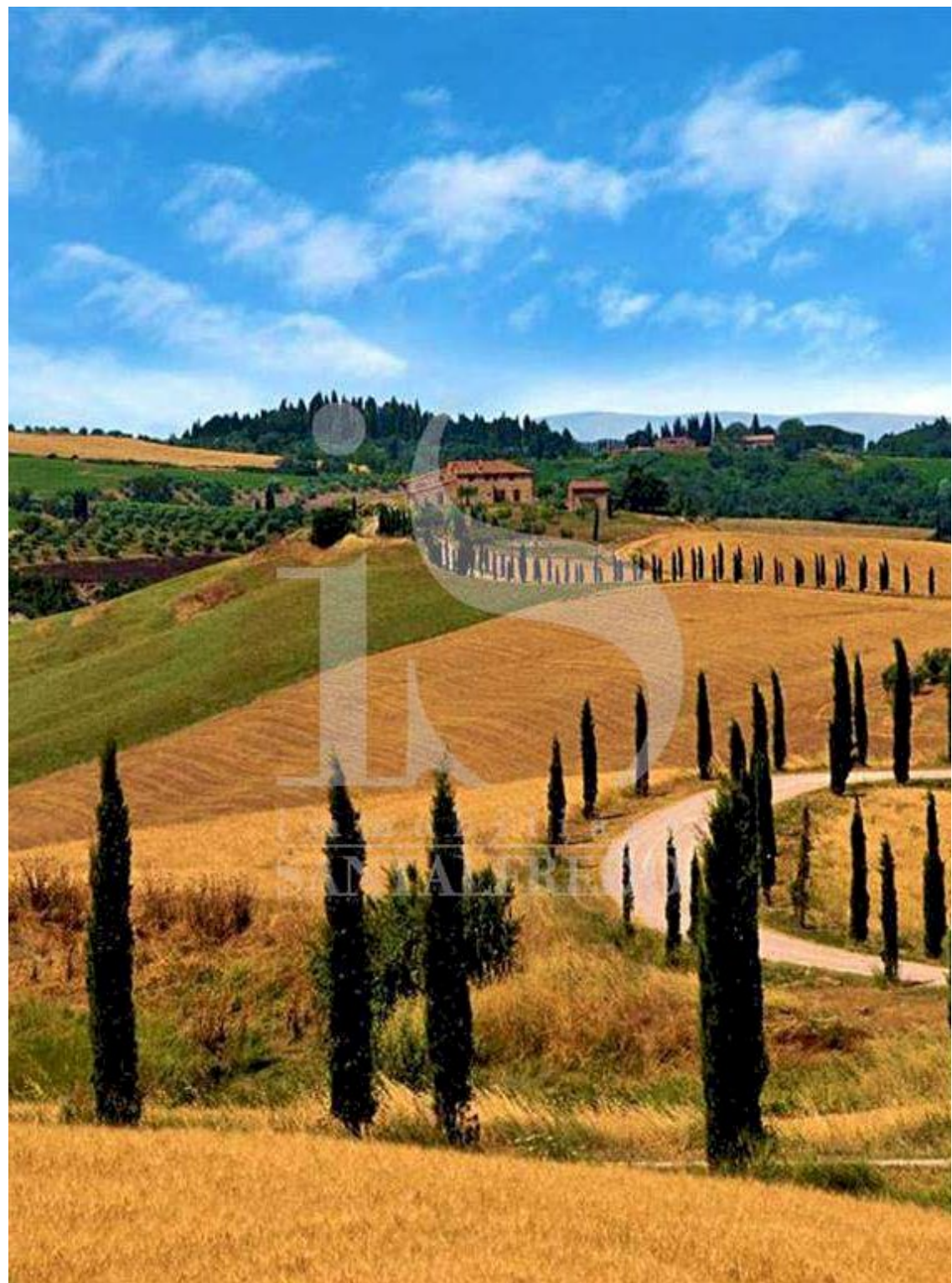

DESCRIZIONE

... Tyrrhenian coast. Within this context, guests can enjoy a relaxing swimming pool, a tennis court and a wide panorama. a covered parking space. Superb land-roof of about 130 square meters, beautifully renovated in the two thousand years. The property is on two levels: the ground floor living area consists of a large living room of 30 square meters, double room, kitchen and service. The sleeping area located on the first floor consists of two double ...

Immobiliare Santalfredo può consigliarti i passi migliori per concretizzare l'acquisto o la vendita di un immobile, guidandoti nel tuo investimento immobiliare in modo attento ed produttivo.

... bedrooms and two bathrooms. All rooms are already furnished. The apartment has a garage and independent heating. Immediately available, for appointments and additional information, Immobiliare Santalfredo 0396908137



Telefono: 039 690 81 37 - Email: info@immobiliaresantalfredo.it



immobiliare
PALEREDO

DETTAGLI AGGIUNTIVI

130 mq | 5 locali | 3 bagni

- Stato al rogito | available
- Piano | su più livelli
- Totale piani edificio | 1
- Numero locali | 5
- Camere da letto | 3
- Cucina | Kitchen-dinner
- Balconi | 0
- Mansarda | No
- Taverna | No
- Cantina | No
- Piscina | No
- Tipo garage | Posto auto esclusivo
- Pavimenti soggiorno | Cotto
- Pavimenti cucina | Cotto
- Pavimenti taverna | Cotto
- Numero servizi finestra | 2
- Fonte riscaldamento | Independent
- Tipo riscaldamento | Caldaia
- Allarme | No
- Portineria | No
- Ascensore | No
- Classe energetica | F
- Indice di prestazione energetica | 175.15
- Giardino | Common



Telefono: 039 690 81 37 - Email: info@immobiliariesantalfredo.it

GALLERIA IMMAGINI



PLANIMETRIA

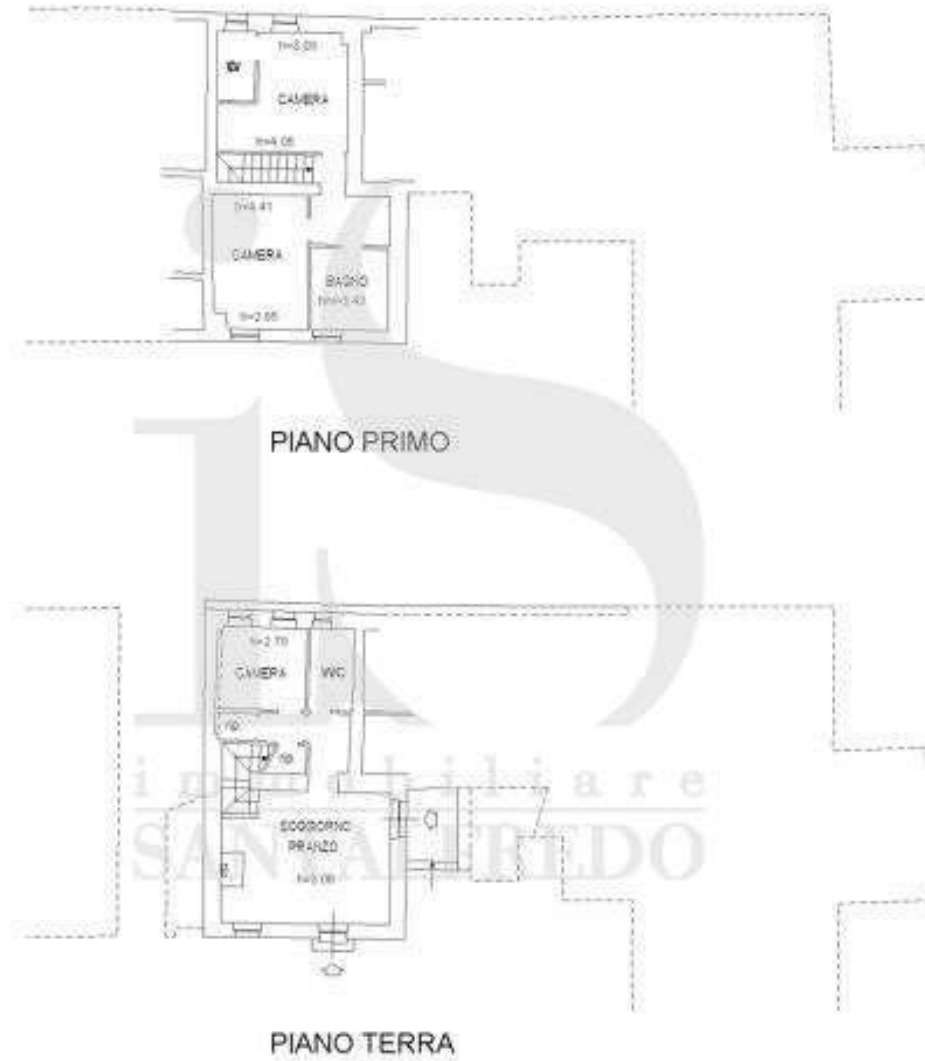



Immobiliare Santalfredo
Via Remo Brambilla, 7
20863 Concorezzo (MB)

Telefono: 039 690 81 37

Email: info@immobiliariesantalfredo.it

Sito Web: <https://www.immobiliariesantalfredo.it>